

THE SILK STORE

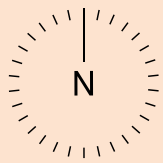

GROUND LEVEL (SPECULATIVE LAYOUT) 4,564 sq ft

- 1 × 4 PERSON MEETING ROOM
- 1 × 14 PERSON BOARDROOM
- 24 × FIXED DESKS
- 18 × HOT DESKS
- VARIOUS BREAK OUT AREAS

KEY

OFFICES

LIFTS

Due to the historic nature of the warehouse, variations across dimensions are expected, therefore these are approximate. Indicative staircase and mezzanine as shown on plans.

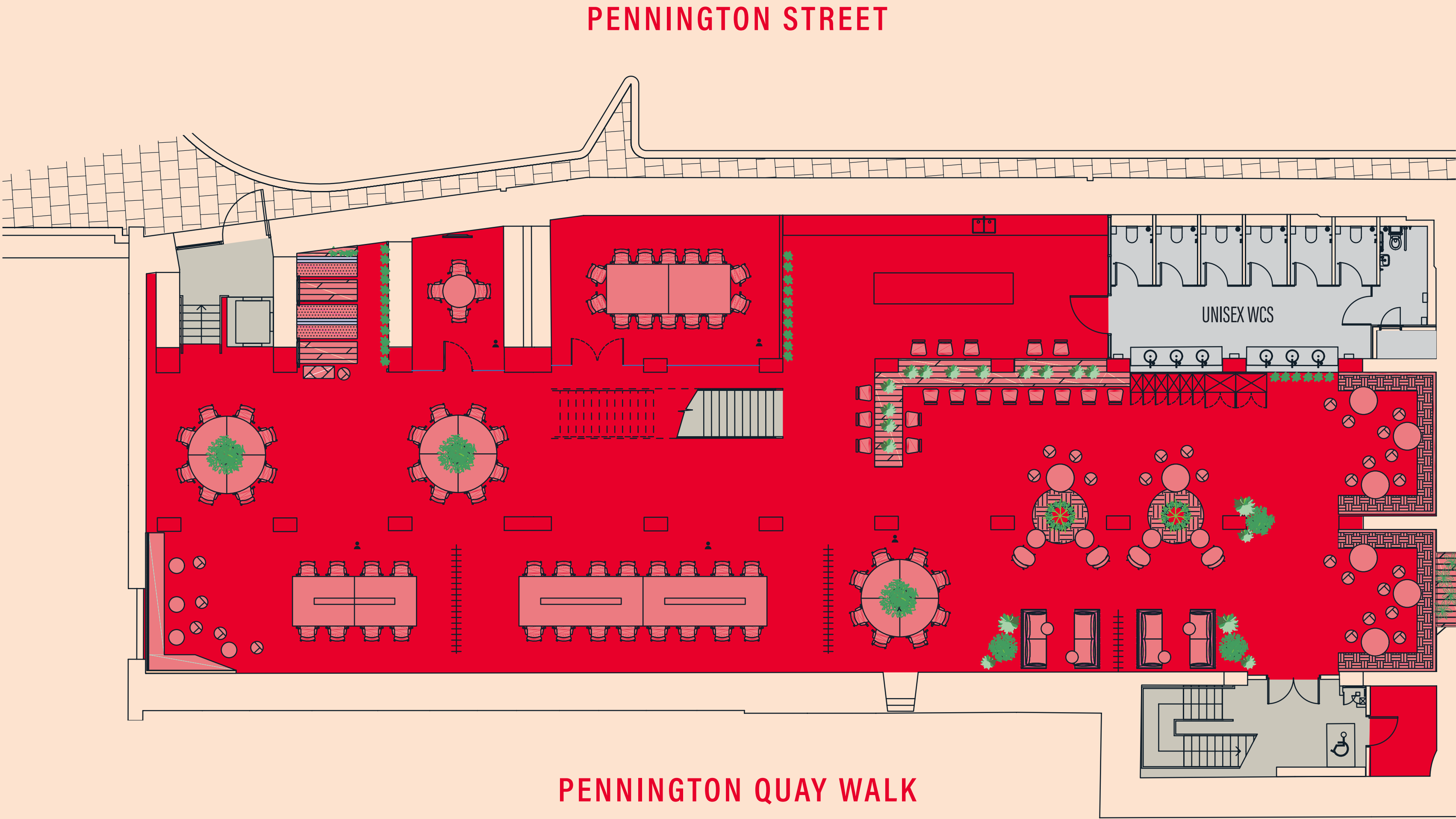

THE SILK STORE

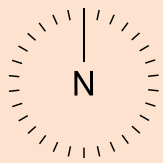

PENNINGTON STREET

QUAY WALK LEVEL
(SPECULATIVE LAYOUT)
4,779 sq ft

- RECEPTION AREA
- 1 × PRIVATE OFFICE
- 44 × FIXED DESKS
- 1 × 6 PERSON MEETING ROOM
- 1 × 5 PERSON MEETING ROOM
- 11 × HOT DESKS
- VARIOUS BREAK OUT AREAS

KEY

OFFICES

EXTERNAL TERRACE

LIFTS

Due to the historic nature of the warehouse, variations across dimensions are expected, therefore these are approximate. Indicative staircase and mezzanine as shown on plans.

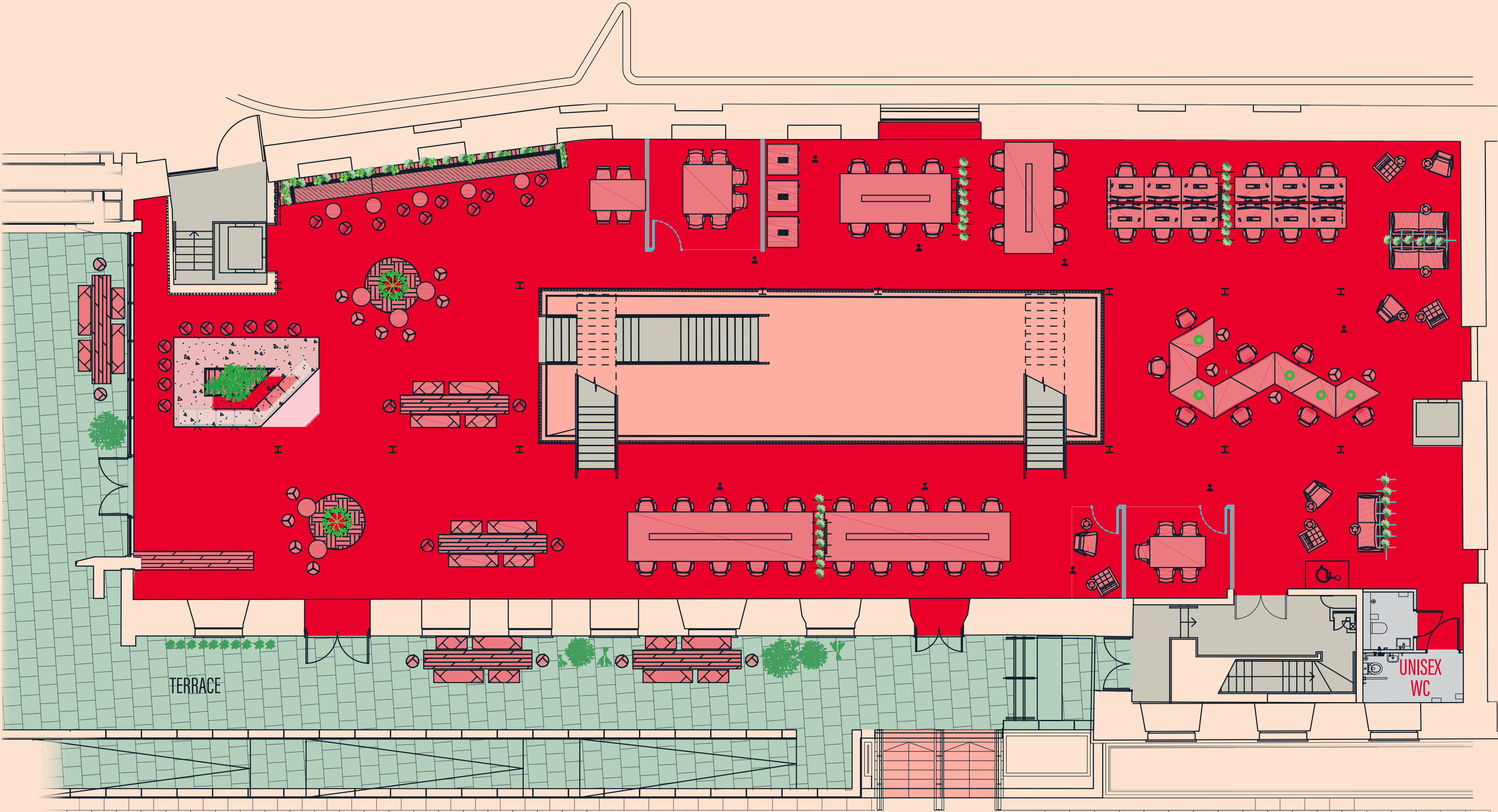

PENNINGTON QUAY WALK

THE SILK STORE

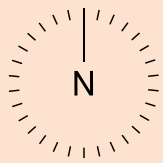

LEVEL 1 (SPECULATIVE LAYOUT) 2,852 sq ft

- 12 × FIXED DESKS
- 1 × 12 PERSON BOARDROOM
- 1 × BREAKOUT AREA
- 6 × HOT DESKS

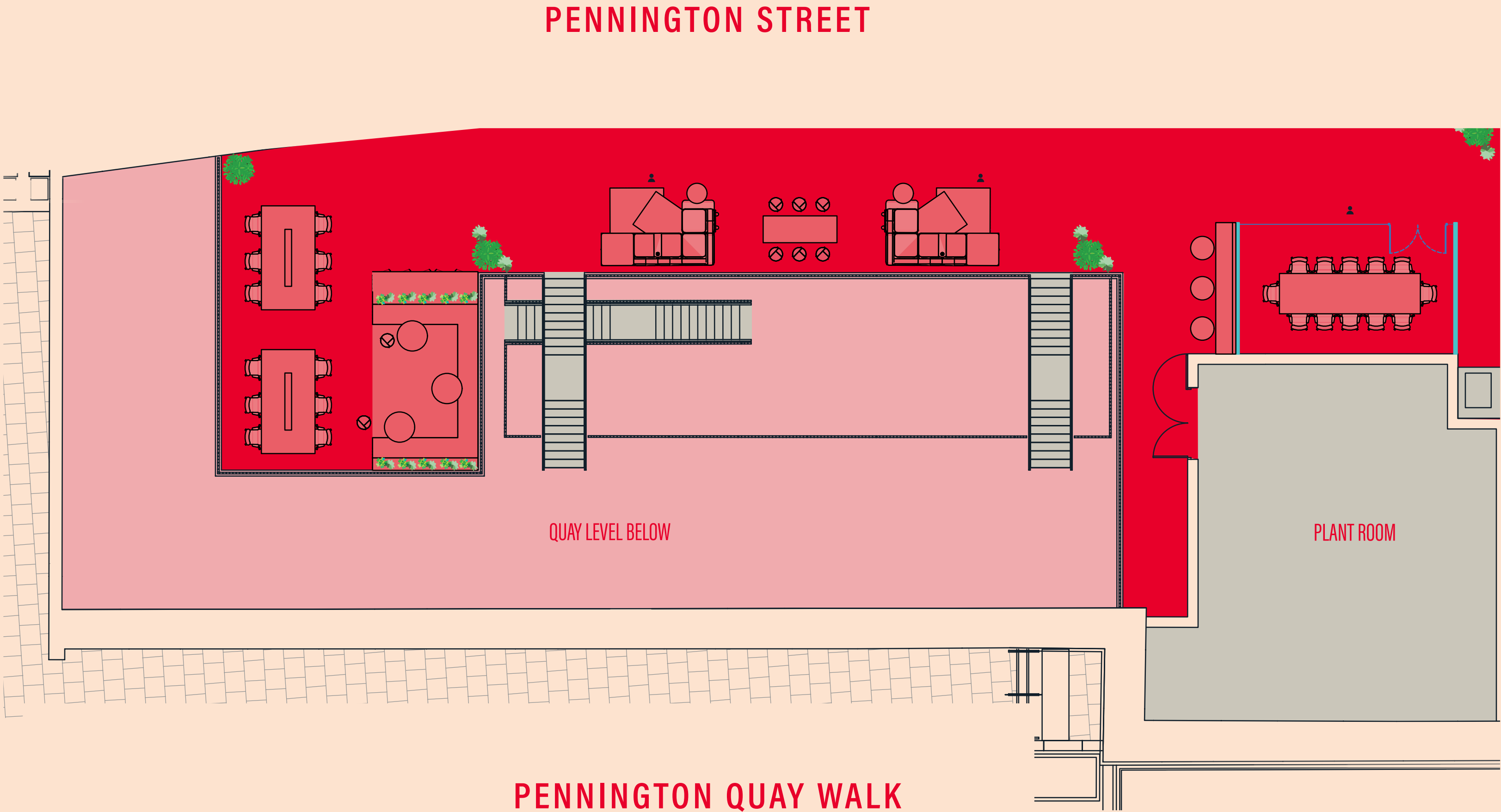

- KEY
- OFFICES
 - LIFTS

Due to the historic nature of the warehouse, variations across dimensions are expected, therefore these are approximate. Indicative staircase and mezzanine as shown on plans.